



## Ohio Program Evaluators' Group 2008 Spring Evaluators' Exchange

Friday, May 16, 2008

The Fawcett Center  
The Ohio State University Campus

The *Evaluators' Exchange* provides a forum for Ohio Program Evaluator's Group (OPEG) members to present their research and evaluation work to colleagues statewide. It also provides a valuable opportunity to learn from expert keynote speakers and network with evaluators and other professionals working in various fields and disciplines.

### Policy Evaluation: What is it, who is doing it, and how?

This year's Spring Exchange features two keynote speakers: 1) Mary Lou Rush, Ph.D., Executive Director, Ohio Department of Education Center for Students, Families, and Communities, and 2) Ann McCracken, Ph.D., Director of Evaluation, Health Foundation of Greater Cincinnati. These distinguished professionals will discuss frameworks, best practices, and challenges related to policy evaluation. During breakout sessions, OPEG members will share strategies, resources, and lessons learned from their experiences with policy evaluation as well as general evaluation practice.

# Map of The Fawcett Center

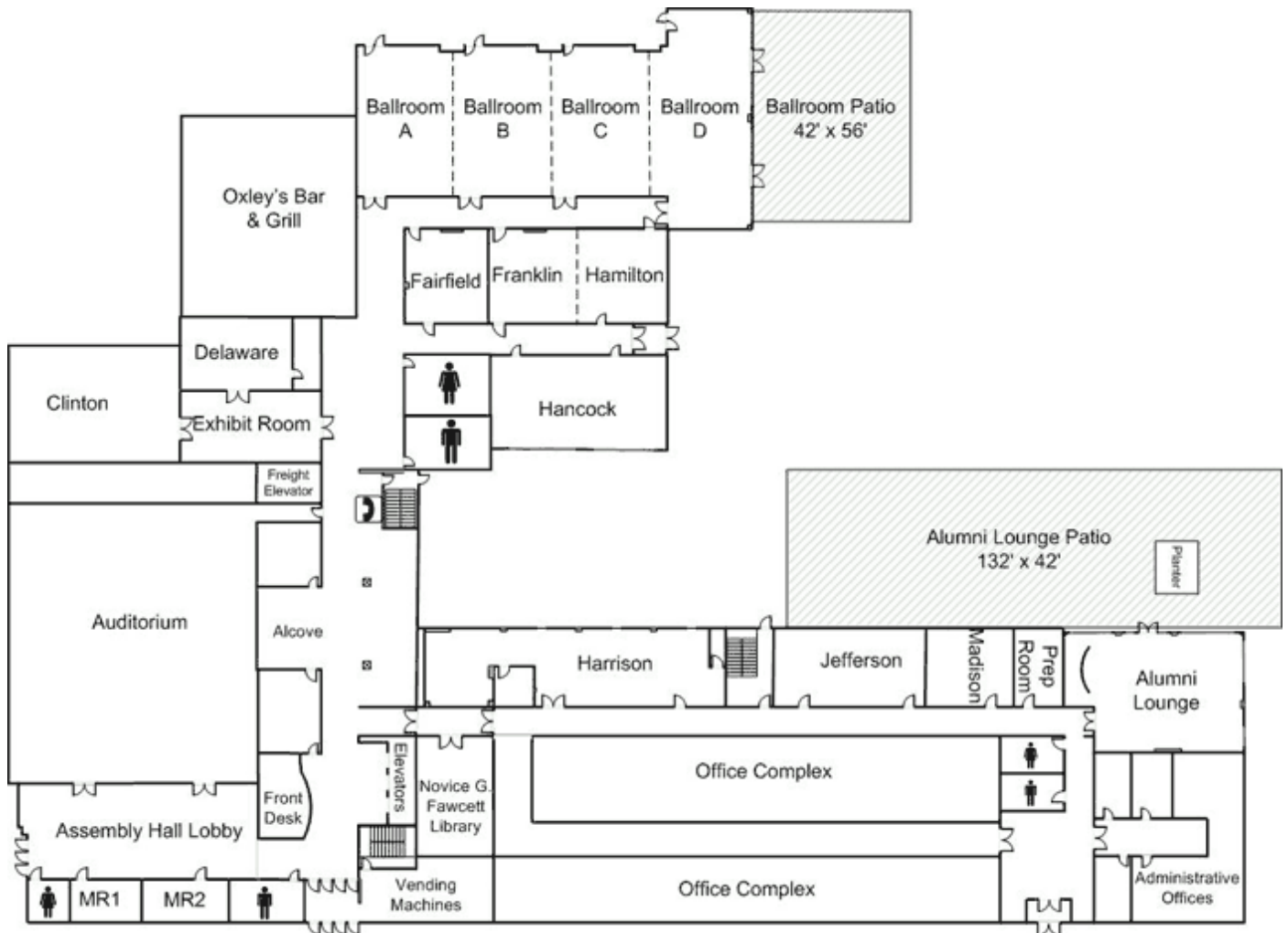

## AGENDA

### Ohio Program Evaluators' Group 2008 Spring Exchange Friday, May 16, 2008

8:30 AM	Registration, breakfast, and networking		
9:00 AM	<b>Opening Session</b> (Ball Rooms A, B, & C) <b>What is OPEG?</b> Nancy Hood, OPEG Vice-President		
9:15 AM	<b>Keynote Presentations</b> (Ball Rooms A, B, & C) <b>A State Government Perspective on Policy Evaluation: The Ohio Department of Education's Equal Access to Learning Opportunities Policy</b> , Mary Lou Rush, Ph.D.  <b>Policy Evaluation: The Baby and the Bathwater</b> , Ann McCracken, Ph.D.  <b>Moderator:</b> Julianne Manchester, Ph.D., OPEG Program Committee Member		
10:45 AM	Break		
<b>BREAK OUT SESSIONS</b>			
	<b>Franklin/Hamilton</b>	<b>Hancock</b>	<b>Clinton</b>
11:00-11:45 AM	<b>1A</b> Structural equation modeling for evaluators - <i>Jerry Bean, Ph.D.</i>	<b>1B</b> Promoting child health: Monitoring SCHIP enrollment and utilization to assess change over time - <i>Rob Fischer, Ph.D.</i>	<b>1C</b> Tracking alcohol and other drug treatment services across levels of care and treatment providers - <i>Thomas Williams, M.A., M.Ed. &amp; Laura Lambert, M.P.H.</i>
12:00 PM	<b>LUNCH: Networking and Annual Membership Meeting</b> Robert Fischer, OPEG President Ball Rooms A, B, & C		
<b>BREAK OUT SESSIONS</b>			
	<b>Franklin/Hamilton</b>	<b>Hancock</b>	<b>Clinton</b>
1:00-1:45 PM	<b>2A</b> Evaluating legal representation and juvenile court services for incarcerated minority juvenile offenders in Cleveland, Ohio - <i>Christopher Mallett, Ph.D., J.D., LISW</i>	<b>2B</b> It's a FACT: Evaluating a program for adults with severe mental illness involved with the criminal justice system - <i>Jonas Thom, M.A., P.C.C. &amp; Angie Rollins, Ph.D.</i>	<b>2C</b> Best practices: Web-based surveys - <i>Thomas Archer, Ph.D.</i>
2:00-2:45 PM	<b>3A</b> Evaluation capacity building to get birds of a different feather to fly together - <i>Stacey Farber, Ph.D.</i>	<b>3B</b> Real world challenges in policy evaluation: Lessons learned from studies of local smoking bans - <i>Elizabeth Klein, Ph.D.</i>	<b>3C</b> Model utilization in the evaluation of linking clients to services: A methodological review - <i>R. Thomas Sherba, M.P.H., M.S. &amp; Thomas Williams, M.A., M.Ed.</i>
3:00 PM	Break (Refreshments in lobby)		
3:15 PM	<b>Closing Session</b> (Clinton Room)  <b>Notes on Policy Evaluation: Reflections of a Pracademic</b> , Beth Honadle, Ph.D.		
4:00 PM	Adjournment		

## Keynote Speakers

**Dr. Mary Lou Rush** is Executive Director of the Center for Students, Families, and Communities at The Ohio Department of Education (ODE). As a 17-year veteran of state government, she is a senior staff member at ODE and her primary responsibilities include bringing leadership and technical expertise to interagency, department, center, and office-level work, and to ensure staff performs at the highest level possible. One of Dr. Rush's current priorities is to develop, implement, and evaluate statewide policies related to reducing barriers to student learning and "getting the conditions right" in schools for staff and students. Dr. Rush, an Educational Psychologist, is also responsible for coordinating family and community engagement policies across ODE and for budget development, research, and evaluation within the Center for Students, Families, and Communities, which includes the following offices: Exceptional Children (Special, Gifted and Limited English Proficient Education); Early Childhood Education; Safety, Health and Nutrition; and Literacy. Dr. Rush must ensure that ODE policies are in alignment with the strategic plan of the State Board of Education of Ohio.

**Dr. Ann L. McCracken** has been the Director of Evaluation at the Health Foundation of Greater Cincinnati for the past ten years. She works with grantees to evaluate funded projects, the program department to evaluate strategy impact, and with external evaluators to evaluate clusters of grants. Prior to working at the Foundation she was a Professor at the University of Cincinnati where she was a two-time Fulbright Scholar in Norway and in Australia. She has published and presented in health and in philanthropy nationally and internationally. Her latest publication on logic models appeared in the Brazilian periodical *Ensaio*. She also directs the internship program at the Foundation.

## Closing Session Speaker

**Dr. Beth Walter Honadle** has been Director of the Institute for Policy Research and Professor of Political Science at the University of Cincinnati since 2004. Dr. Honadle is a leading authority in the field of public administration and public policy. She has extensive experience in government and academia, including eleven years at the U.S. Department of Agriculture, nine years as a Professor in the Department of Applied Economics at the University of Minnesota, and five years as a Professor of Political Science at Bowling Green State University where she directed the Center for Policy Analysis & Public Service. She has also been an international consultant in Egypt and Ukraine. She has been the Principal Investigator on numerous projects and has testified before U.S. and state legislative subcommittees. Dr. Honadle has published extensively, including books and articles. Her scholarly interests include policy analysis and evaluation, intergovernmental relations, community and economic development, and fiscal health.